



97TH ANNUAL CONVENTION OF THE

KENTUCKY FFA ASSOCIATION



JUNE 8-11, 2026
CENTRAL BANK
CENTER
LEXINGTON, KY

First Southern National Bank

Financial wisdom. Flourishing lives.

Member
FDIC

FSNB.NET



First Southern National Bank recommends:

GIVE, SAVE, SPEND

*A Personal Finance Class with
a Biblical Worldview*

Use the QR to learn more:

- Satisfies State of Kentucky High School Financial Literacy credit
- Dual Enrollment Available (3 hours College Credit)
- 100% Online
- Scholarships available



SCAN ME

In partnership with Asbury University and Compass Financial Ministry



Welcome to the **97th Annual Kentucky FFA State Convention!**

Kentucky FFA members, guests, and advisors, welcome to Lexington for the 97th Kentucky FFA State Convention. Each of us has the ability to make an impact on the agriculture industry and the world around us. When we use our talents and time to serve others, we open the door to greater impact, personal growth, and meaningful connections.

Throughout this convention, and even after we leave Lexington, we hope you feel inspired and confident, knowing that you are truly *Bound for More!*

FOLLOW KENTUCKY FFA ON SOCIAL MEDIA:



@kentuckyffa



Kentucky FFA
Association



@Kentucky FFA



Kentucky FFA

State FFA Officers

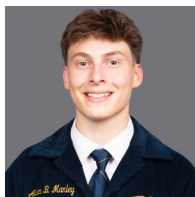

AIDEN MANLEY

State President
Menifee County
Licking River Region

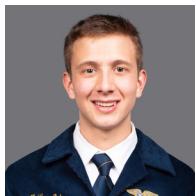

MATTHEW ESTES

State Vice President
Barren County
Barren River Region

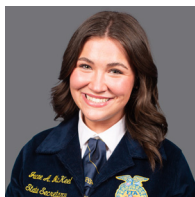

JACEE MCKEEL

State Secretary
Calloway County
Purchase Region

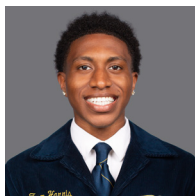

TYREN HARRIS

State Treasurer
Carter G. Woodson
Bluegrass Region

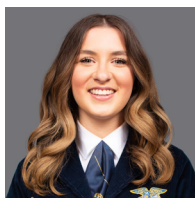

SIERRA MORRIS

State Reporter
Western Hills
Capital City Region

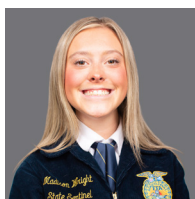

MADISON WRIGHT

State Sentinel
Owen County
Northern Kentucky Region

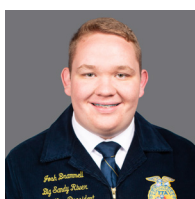

JOSH BRAMMELL

Big Sandy River
State Vice President
East Carter



ANNA CHALIFF

Kentucky River
State Vice President
Rockcastle County



CLINTON CORNER

Lake Cumberland
State Vice President
Pulaski County



MIKAYLA FIELDS

Green River
State Vice President
Ohio County



MOLLIE GOODE

Pennyrile
State Vice President
Hopkinsville



DAWSON HALL

Lincoln Trail
State Vice President
John Hardin



State FFA Staff

MATT CHALIFF

Executive Secretary

SHELDON MCKINNEY

FFA Foundation Director

KRISTAN WRIGHT

State Advisor

JOSH MITCHAM

*Director, Carol Martin Gatton
KY FFA LTC*

SCAN THIS QR CODE:

*See FFA facts, history and
photo archives!*



2026 Convention T-Shirt

\$10



front detail



back detail

AVAILABLE FOR PURCHASE
IN THE EXPO

Kentucky FFA State Convention 5, 4 & 3-Star Sponsors



THE
BILL GATTON
FOUNDATION
Building Bridges to Span the Tide



farmCREDIT
MID-AMERICA

**First
Southern**
National Bank

Financial wisdom. Flourishing lives.



KENTUCKY
DEPARTMENT OF
AGRICULTURE



KENTUCKY STATE
UNIVERSITY
College of Agriculture, Health,
and Natural Resources



Nutrien
Ag Solutions®

AGCO
Your Agriculture Company

DARLING
INGREDIENTS



ARMY ROTC

Nick Carter
Kentucky FFA
Foundation
Trustee

KENTUCKY
CATLEMEN'S
ASSOCIATION





GROWING KENTUCKY **AGRICULTURE**

Proudly supporting Kentucky FFA and the next generation of agricultural leaders in food, farming and innovation.

kyagr.com



LEVEL ONE

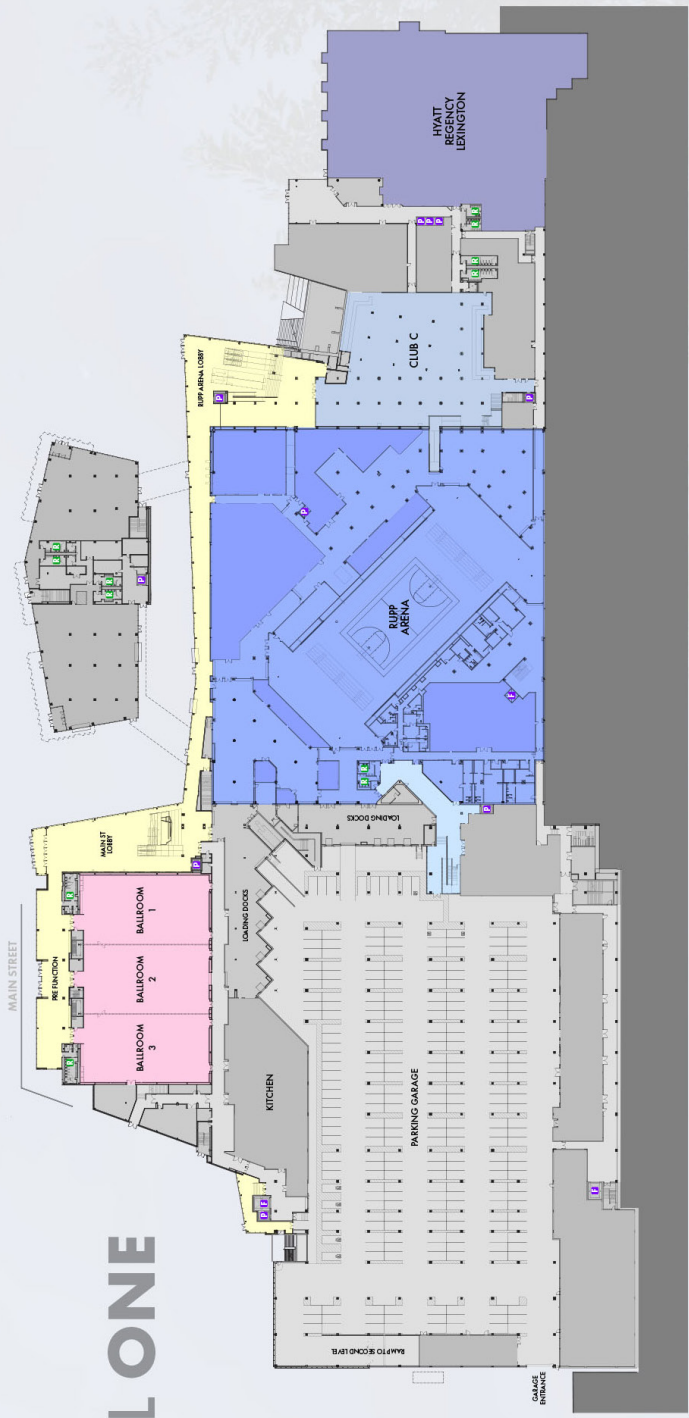

LEVEL TWO



Welcome & Good
Luck to all
FFA members!



Middle School FFA Contests

MONDAY, JUNE 8

Extemporaneous Preparation Room

10:00 a.m. Room 8, CBC

Prepared Public Speaking A

10:30 a.m. Room 14A, CBC

Prepared Public Speaking B

10:30 a.m. Room 14B, CBC

Extemporaneous A

10:30 a.m. Room 12, CBC

Extemporaneous B

10:30 a.m. Room 13, CBC

Opening & Closing Ceremonies A

10:30 a.m. Room 10, CBC

Opening & Closing Ceremonies B

10:30 a.m. Room 11, CBC

Middle School Agricultural Issues Discussion Meet

10:30 a.m. Room 7, CBC

Written Quiz Bowl

11:15 a.m., 12:00 p.m. Room 8, CBC

Extemporaneous Finals

12:30 p.m. Room 12, CBC

Public Speaking Finals

1:00 p.m. Room 14A, CBC

Opening and Closing Ceremonies Finals

1:00 p.m. Room 11, CBC

Oral Quiz Bowl

2:30 p.m. Room 8, CBC

CONTEST LOCATIONS KEY

HR = Hyatt Regency

HLD = Hilton Lexington Downtown

CBC = Central Bank Center



The shortest path to a job done right.

KubotaUSA.com

GROWING THE NEXT GENERATION OF LEADERS

UK Martin-Gatton
College of Agriculture,
Food and Environment



EDUCATION REIMBURSEMENT

SAVE UP TO \$35,000 OVER 6 YEARS PERIOD

CONTACT EMPLOYMENT@HRAGRIPOWER.COM FOR MORE INFORMATION



HOPKINSVILLE, KY
270-886-3918

RUSSELLVILLE, KY
270-726-4545

OWENSBORO, KY
270-926-2627

MORGANFIELD KY
270-389-1424

MAYFIELD, KY
270-247-4747

High School FFA Contests

TUESDAY, JUNE 9

Parliamentary Procedure Test

10:00 a.m. Patterson C-D, HR

Extemporaneous Preparation Room Opens

Report at scheduled times.

10:30 a.m. Jessamine/Franklin, HR

Agriculture Public Speaking

Report at scheduled times.

Ag Public — Agriculture Mechanics Room 1, CBC

Ag Public — Beef Room 2, CBC

Ag Public — Crop Room 3, CBC

Ag Public — Dairy Room 4, CBC

Ag Public — Floral Room 5, CBC

Ag Public — Fruit & Vegetable Room 6, CBC

Ag Public — Goat & Sheep Room 7, CBC

Ag Public — Greenhouse Room 8, CBC

Ag Public — Horse Room 10, CBC

Ag Public — Nursery & Landscape Room 11, CBC

Ag Public — Poultry Room 12, CBC

Ag Public — Small Animal Room 13, CBC

Ag Public — Swine Room 14A, CBC

Ag Public — Turf & Lawn Room 14B, CBC

Extemporaneous

Report at scheduled times Scott/Woodford, HR

Conduct of Chapter Meetings

11:00 a.m. Regency 3, HR

Prepared Public Speaking

11:00 a.m. Patterson A & Berea, HR

FFA Creed Speaking

11:00 a.m. Regency 1 & 2, HR

AIC Written Exam

11:00 a.m. Mary Todd Lincoln, HR

AIC Oral Questions

11:00 a.m. Henry Clay, HR

Farm Business Management

11:00 a.m. Patterson E-G, HR

Talent

11:00 a.m. Exhibit Hall B, CBC

Record Keeping CDE

2:00 p.m. Patterson C-D, HR

WEDNESDAY, JUNE 10

The Cralle
Foundation 
Agriscience Fair Sponsors

Agriscience Fair

8:00 a.m. Ballroom 1, CBC

Employment Skills LDE

8:30 a.m. Rooms 1 & 2, CBC

Parliamentary Procedure LDE Preliminary Rounds

8:30 a.m. Regency I-III, HR

Creed Speaking Finals

8:30 a.m. Exhibit Hall B, CBC

Spanish Creed Invitational

8:30 a.m. Patterson A-B

Quiz Bowl Contest

9:30 a.m. Room 3, CBC

Prepared Public Speaking Finals

9:30 a.m. Exhibit Hall B, CBC

Extemporaneous Public Speaking Finals

10:30 a.m. Exhibit Hall B, CBC

Agricultural Sales CDE

11:30 a.m. Hilton, 2nd Floor

Quiz Contest

11:30 a.m. Exhibit Hall B, CBC

Parliamentary Procedure LDE Finals

1:00 p.m. Regency I, HR

Marketing Plan CDE

1:00 p.m. Rooms 13, 14A & 14B, CBC

Agricultural Issues LDE

1:00 p.m. Room 12 CBC

Star Interview Waiting Room

1:00 p.m. Room 4, CBC

Star Farmer Interviews

1:00 p.m. Room 1, CBC

Star in Agribusiness Interviews

1:00 p.m. Room 2, CBC

Star in Agricultural Placement Interviews

1:00 p.m. Room 3, CBC

Leadership Workshops

Sponsored by Farm Credit Mid-America

TUESDAY, JUNE 9

Find Your Place in Ag

Presented by Teach Ag Ambassadors

11:00 AM & 1:00 PM, Ballroom A, HLD



Bound for More: Where are you now and where are you headed? Could a career in Agricultural Education be the right path for you? Take a journey with us to discover where your future is headed and how to prepare along the way!

The Power of One Voice

Presented by Kentucky Farm Bureau

11:00 AM & 1:00 PM, Ballroom B, HLD



This fast-moving, interactive session gives you the chance to jump into agriculture advocacy challenges through crafting messages, sharing personal ag stories, and testing how your voice can shape the future of agriculture and rural communities.

Bound for Impact KDA x FFA

*Presented by Kentucky
Department of Agriculture*

11:00 AM & 1:00 PM, Ballroom C, HLD



KENTUCKY
DEPARTMENT OF
AGRICULTURE

Equipping FFA members with the knowledge, leadership, and voice to champion agriculture education in their communities.

Lights, Camera, Network: Building Your Network Through Communication

Presented by Mary Brooke Stith

11:00 AM & 1:00 PM, Ballroom D, HLD

Effective leaders know that success is built on strong relationships. Just like any great movie production depends on the right cast, this workshop highlights the importance of communication and networking in creating meaningful connections. Members will gain a deeper understanding of how to present themselves, engage with others, and build a network that contributes to long-term success.

WEDNESDAY, JUNE 10

Growing Solutions for the Future of Agriculture

Presented by Farm Credit

Mid-America

11:00 AM & 1:00 PM, Room 5, CBC



An interactive workshop designed to empower young leaders to solve challenges facing the future of agriculture. You'll explore the impact of agriculture in Kentucky, reflect on existing roadblocks to your local agriculture community, and exercise your innovator mindset in an agricultural themed solving session. You'll leave the workshop with a renewed sense of purpose rooted in sustaining the future of agriculture

Simple is Significant

Presented by Lilly Nyland, National FFA Secretary

10:00 AM, 11:00 AM & 1:00 PM, Room 6, CBC

Some of the most significant moments are often the simplest ones. In this workshop, we will explore the power of small moments and learn how intentional actions can turn them into meaningful, lasting impact.

Financial Wisdom. Flourishing Lives.

Presented by First Southern

National Bank

11:00 AM & 1:00 PM, Room 7, CBC



We'll discuss what it means to have margin in your home and creating a legacy for your family that can impact the world.

Are You Ready to Teach? Exploring Agricultural Education Through Action

Presented by Teach Ag

11:00 AM & 1:00 PM, Room 8, CBC



Participants in this workshop will understand what agricultural education looks like beyond the classroom and practice using basic teaching skills in a fun, interactive way.

Important Events and Info

Expo Hours

Tuesday, June 9, 10:00 a.m.-3:00 p.m.

Wednesday, June 10: 8:00 a.m.-1:00 p.m.

Teacher's Lounge w/ complimentary coffee & drinks provided in the Darling Ingredients booth.

Food Court Hours Located in Club B, CBC.

Opens 11:00 a.m. Monday-Wednesday

Teacher Headshots

Tuesday, June 9, 11:00 a.m.-2:00 p.m. Near registration

Shark Tank Presentations

Tuesday, June 9, 1:00 p.m. Spotlight Stage
Exhibit Hall B, CBC

WLC Bus Trip Participants Meeting

Tuesday, June 9, 9:00 p.m. Exhibit Hall B, CBC

Kentucky FFA's Got Talent

Tuesday, June 9, 9:30 p.m. Exhibit Hall C, CBC
Members and advisors only – must have arm band to enter.

Delegate Business Session

Wednesday, June 10, 9:00 a.m. Exhibit Hall C, CBC

Kentucky Beef Council's Youth Beef Advocate Proclamation

Wednesday, June 10, 9:00 a.m. Room 8, CBC

Advisors Pick up Checks

Wednesday, June 10, 10:00 p.m. Exhibit Hall B, CBC
Thursday, June 11, 8:00 a.m. Exhibit Hall B, CBC

Kentucky FFA Dance

Wednesday, June 10, 10:00 p.m. Exhibit Hall B, CBC
Members and advisors only – must have arm band to enter.

Meal Functions

TUES. 6/9

Judges Breakfast

9:30 a.m.,
Hyatt Regency,
Thoroughbred
Ballrooms

Administrator Appreciation Lunch

12:30 p.m.,
Hyatt Regency,
Patterson B

Past State FFA Officer Dinner (ticketed event)

5:30 p.m.,
Hyatt Regency,
Thoroughbred
Ballrooms

WED. 6/10

Judges Luncheon

11:45 a.m.,
Hyatt Regency,
Thoroughbred
Ballrooms

Sponsors Dinner

5:30 p.m., Central
Bank Center Hall B

THURS. 6/11

Star Breakfast

7:30 a.m., Hyatt
Regency,
Thoroughbred
Ballrooms

Retired & Newly Elected Officers Lunch

11:30 p.m.,
Hyatt Regency,
Thoroughbred 1-3

It's a good day to

THANK A FARMER



**Advocating for farmers, because
they bring more to the table than food.**

Since 1919, Kentucky Farm Bureau has stood beside the farm families and rural communities that sustain the Commonwealth. These men and women are the backbone of our economy, our traditions, and our way of life. We continue to ensure the challenges facing Kentucky agriculture are heard and addressed by decision-makers in Frankfort and Washington, D.C.



KENTUCKY FARM BUREAU

SESSION 1

TUESDAY, JUNE 9, 3:30 P.M.
EXHIBIT HALL C, CBC

Session Chair

Aiden Manley, *State President*

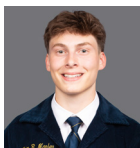

Opening Ceremonies

Convention Welcome

Sierra Morris,
State Reporter
Madison Wright,
State Sentinel



Session Welcome

Aiden Manley, *State President*

Chartering of New Chapters

Middle School Contest Awards

Middle School Quiz Bowl
Murray State University Collegiate FFA

Prepared Public Speaking
Gro-Tec

Extemporaneous Public Speaking
Dr. Rodney Tulloch

Opening and Closing Ceremonies
The Bill Gatton Foundation

Essay Contest
Kentucky Propane Gas Association

Ag Issues Discussion Meet
The Bill Gatton Foundation

Keynote Address

Coty Back

*Former Kentucky State Officer,
National FFA Officer, and now a
leadership coach with a focus on
developing teams and culture.*



Closing Ceremony





FEEDING THE FUTURE

is THE REASON we come to work each day

As the *world's largest agricultural retailer*, Nutrien Ag Solutions® is helping farmers grow more food with the most sustainable solutions possible to feed a growing global population.

Investing in our people is a key part of ensuring we can Feed the Future, Together. From small towns to big cities, Nutrien Ag Solutions offers exciting career opportunities that *suit your lifestyle*.

Join our team and *grow your career* while helping growers leverage the latest technologies, products and services.



Agronomy



Seed



Nutrition



Protection



Financial



Sustainability

Nutrien
Ag Solutions®

jobs.nutrien.com



Scan the QR code to find the right position for you!

SESSION 2

TUESDAY, JUNE 9, 7:30 P.M.
EXHIBIT HALL C, CBC

Session Chairs

Josh Brammell,
Big Sandy River State
Vice President



Anna Chaliff,
Kentucky River State
Vice President

Opening Ceremonies

Recognition of Anniversary Officer Teams

Introduction of State Officer Candidates

State Officer Report

Jacee McKeel,
State Secretary



Tyren Harris
State Treasurer

Membership Recognition

Keynote Address

Lilly Nyland, *National FFA Secretary*



Advisor & Mentor Recognition

Kentucky Chapter Rating Contest Awards

Kentucky Department of Agriculture

Kentucky FFA Chapter Contest Awards

Kentucky Department of Agriculture

Closing Ceremony



Join the
**THOROBRED
FAMILY!**

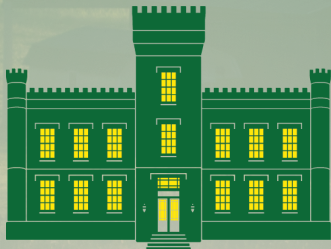

**KENTUCKY STATE
UNIVERSITY**

College of Agriculture, Health,
and Natural Resources

**Got GRIT? Got GOALS?
Visit the KSU Booth!**

Grab some swag and learn how YOU
can turn your passion for Ag into a
career that makes a difference!

**SMALL SCHOOL. BIG FUTURE.
REAL IMPACT.**

KYSU.edu



@KyStateU

SESSION 3

WEDNESDAY, JUNE 10, 2:30 P.M.
EXHIBIT HALL C, CBC

Session Chairs

Clinton Corner,
Lake Cumberland State
Vice President

Dawson Hall
Lincoln Trail State
Vice President



Opening Ceremony

Agriscience Fair Recognition

ADM and The Cralle Foundation

Greetings from Kentucky 4-H

Retiring Address

Matthew Estes, *State Vice President*

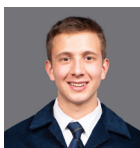

Honorary State FFA Degrees

Proficiency Awards

Closing Ceremony



BILL GATTON LEADERSHIP AWARDS PROGRAM

All proficiency, CDE and LDE participants will receive support from the Bill Gatton Foundation in addition to support from generous sponsors.



Wildlife Management.....	The Bill Gatton Foundation
Veterinary Science.....	The Bill Gatton Foundation
Vegetable Production.....	Nick Carter
Turf Grass Mgmt... Bluegrass Region FFA In Memory of Neal Floyd	
Swine Production-Ent.	Kentucky Pork Producers
Swine Production-Placement.....	Kentucky Pork Producers
Specialty Crop Production.....	Ky. Small Grain Growers Association

Specialty Animal Production Randal Williamson
 Small Animal Production and Care The Bill Gatton Foundation
 Sheep Production Mr. Billy Ray Smith
 Service Learning The Bill Gatton Foundation
 Poultry Production Kentucky Poultry Federation
 Outdoor Recreation Dr. Tony & Lisa Brannon
 Nursery Operations The Bill Gatton Foundation
 Landscape Management Pulliam & Associates Consulting
 Grain Production Kentucky Corn Growers Association
 Goat Production Central Kentucky Ag Credit
 Fruit Production Mr. Damon Talley
 Forest Management and Products Kentucky Division of Forestry
 Forage Production Kentucky Young Farmers Association
 Fiber and Oil Crop Kentucky Soybean Promotion Board
 Equine Science-Ent. Hallway Feeds
 Equine Science-Placement Kentucky Retail Federation
 Env. Science & Natural Resources The Bill Gatton Foundation
 Diversified Livestock Production The Lawrence Hall Trust
 Diversified Horticulture Kentucky State Horticultural Society
 Diversified Crop Production-Ent. Syngenta Crop Protection, Inc.
 Diversified Crop Production-Plct. Meade Stock Farm-ALR Farms
 LLC
 Diversified Agricultural Production Jonathan Fox
 Dairy Production-Ent. Robey Farms
 Dairy Production-Plct. Kentucky Dairy Development Council
 Beef Production-Ent. Kentucky Cattlemen's Association
 Beef Production-Plct. Paris Stockyards
 Agriscience Research-Plant Systems 2007-2008 Kentucky
 FFA State Officer Team
 Agriscience Research-Integrated Systems 2007-2008 Kentucky
 FFA State Officer Team
 Agriscience Research-Animal Systems 2007-2008 Kentucky
 FFA State Officer Team
 Agricultural Services Agribusiness Association of Kentucky
 Agricultural Sales-Ent. Southern States
 Agricultural Sales-Plct. Agribusiness Association of Kentucky
 Agricultural Processing Cal Maine Foods
 Ag Mech-Repair and Maintenance Ent. Southern States
 Ag Mech-Repair and Maintenance Plct Cal Maine Foods
 Ag Mech Design and Fabrication Wright Implement
 Agricultural Education Ky. Association of Agricultural Educators
 Agricultural Communications Matt & Betsy London

SESSION 4

WEDNESDAY, JUNE 10, 8:00 P.M.
EXHIBIT HALL C, CBC

Session Chair

Mollie Goode,
Pennyryle State Vice President



Opening Ceremony

Greetings

Commissioner Jonathan Shell,
Kentucky Department of Agriculture



Distinguished Service Award Presentation

Golden Owl Award

Recognition of Kentucky FFA Foundation Sponsors

Career & Leadership Development Event Awards

Closing Ceremony



BILL GATTON LEADERSHIP AWARDS PROGRAM

All proficiency, CDE and LDE participants will receive support from the Bill Gatton Foundation in addition to support from generous sponsors.



Agriculture Essay.....	Nick Carter
AIC.....	The Bill Gatton Foundation
Ag Communications.....	Ryan Brothers
Ag Sales.....	The Stith Brothers
Farm Business Management.....	Fresh Start Farms
Food Science CDE.....	The Bill Gatton Foundation
Marketing Plan.....	The Bill Gatton Foundation
Milk Quality and Products.....	The Bill Gatton Foundation
Record Keeping.....	Jeff and Morrissa Hayes
Environmental Science.....	The Bill Gatton Foundation
Forestry.....	The Bill Gatton Foundation

Horse Evaluation.....	The Bill Gatton Foundation
Poultry	The Bill Gatton Foundation
Veterinary Science.....	The Bill Gatton Foundation
Agricultural Issues.....	The Late John Colliver Endowment
Conduct of Chapter Meetings.....	Kentucky Cattlemen's Association
Employment Skills	The Late Dr. Charles Byers
Parliamentary Procedure	Martin-Gatton College of Agriculture, Food, and Environment
Creed Speaking.....	The Late Dr. Luther and Brenda Hughes Endowment
Extemporaneous Speaking.....	Kentucky Farm Bureau
Prepared Public Speaking	Kentucky Farm Bureau
FFA Quiz.....	The Bill Gatton Foundation
Quiz Bowl.....	The Murray Bank & Furchess Farms Partnership
Talent.....	First Southern National Bank
Ag Public-Ag Mechanics.....	Hutson, Inc.
Ag Public-Beef.....	Little Kentucky Smokehouse
Ag Public-Crop.....	Rip's Farm Center
Ag Public-Dairy.....	Jimmie & Betty Claycomb
Ag Public-Floral.....	The Bill Gatton Foundation
Ag Public-Fruit and Vegetable	UK Martin Gatton College of Agriculture Food and the Environment
Ag Public-Goat and Sheep.....	Ky. Sheep & Goat Development Board
Ag Public-Greenhouse	First Southern National Bank
Ag Public-Horse	The Bill Gatton Foundation
Ag Public-Nursery and Landscape.....	Hardin County Farm Bureau
Ag Public-Poultry.....	Kentucky Poultry Federation
Ag Public-Small Animal.....	Jim David Meats
Ag Public-Swine.....	Kentucky Pork Producers
Ag Public-Turf and Lawn	The Bill Gatton Foundation



LOANS FOR
LAND, FARMS & HOMES IN THE COUNTRY

859-253-3249 AgCreditOnline.com  NMLS #604727

Swing by our booth and sign up for door prize giveaways.

SESSION 5

THURSDAY, JUNE 11, 9:00 A.M.
EXHIBIT HALL C, CBC

Session Chair

Matthew Estes, *State Vice President*



Opening Ceremonies

Retiring Address

Aiden Manley, *State President*

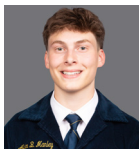

Recognition of State Officer Parents

State Degree Ceremony

Star in Placement Award

Kentucky Farm Bureau

Star in Agribusiness Award

Kentucky Farm Bureau

Star Farmer Award

Farm Credit Mid-America

Nominating Committee Recognition

Nominating Committee Report

Installation of 2026-2027 State Officer Team

Recognition of 2025-2026 State Officer Team

Closing Ceremony





is a proud supporter of
Kentucky FFA



Kentucky FFA State Convention
Two-Star Sponsors



State Degree Candidates

Regional Stars in Agribusiness

Kinsley Taylor..... Logan County
Luke Rayburn..... West Carter
Melanie Planck..... Locust Trace
Carter Hutcherson..... Western Hills
Brian Hawkins..... Apollo
Mallie Johnson..... South Laurel
Grayson Dooley..... Campbellsville
Robert Pease..... Fleming County
Addison Jones..... Marion County
Audrey Roberts..... Owen County
Rex Taggart..... Christian County
Kaden Seaford..... Marshall County

Regional Star Farmers

Klay VanSickle..... Logan County
Brittney Wright..... Elliott County
Will Beckley..... Estill County
Logan Rudd..... Woodford County
Colton Hardy..... Apollo
Austin Van..... North Laurel
Myla Curry..... Adair County
Lauren Ellington Montgomery County
Case Redmon..... Meade County
Brody Hearn..... Owen County
Benjamin Jones..... Caldwell County
Jacob Thorn..... Marshall County

Regional Stars in Agricultural Placement

Lucy Jeffries..... Hart County
Ethan Easterling..... West Carter
Sydnie Wells..... Bourbon County
Lily Clark..... Franklin County
Christopher Stephen..... Apollo
Reese Croley..... Whitley County
Avery Wesley..... Pulaski County
Isaac Stull..... Montgomery County
Cyrus Bivens..... LaRue County
Haylie Thomas..... Harrison County
Will Tabor..... Todd Central
Westen Richardson..... McCracken
County

State Degree Candidates

Samuel Feese..... Adair County
Brayden Fitzgerald..... Adair County
Isabella Harvey..... Adair County
Kantlee Harvey..... Adair County
James Jessie..... Adair County
Katelyn Kean..... Adair County
Amelia Martin..... Adair County
Abby Maulden..... Adair County
Brent Moore..... Adair County
Jordan Willis..... Adair County
Ethan Wooten..... Adair County
Sawyer M. Cunningham.....
Anderson County
Kaelie Jo Jackson..... Anderson County
Camden Layne Mitchell.....
Anderson County
Lilli Boone..... Apollo
Ashlynn Browning..... Apollo
Aubrie Broyles..... Apollo
Ethan Calhoun..... Apollo
Westin Clark..... Apollo
Lillian Connor..... Apollo
Gauge Crabtree..... Apollo
Adelyn Dilback..... Apollo
Anna Dilback..... Apollo
Campbell Dillbeck..... Apollo
Joleson Brady Dunn..... Apollo
Maddie Ebelhar..... Apollo

Will Ebelhar..... Apollo
Jacy Ann-Marie Hatfield..... Apollo
Jessica Faith Lee..... Apollo
David Waltrip..... Apollo
Lucian Winfield..... Apollo
Kahlil Ealey..... Ashland Independent
Ryder Phillips..... Ashland Independent
Lacey Burnley..... Ballard Memorial
Addyson Allen..... Barren County
Jonna Ford..... Barren County
Alana Houchens..... Barren County
Jay Houchens..... Barren County
Holland Kelsay..... Barren County
Kyra Moore..... Barren County
Brooklyn Russell..... Barren County
Jayden Howard..... Bath County
Laylan Howard..... Bath County
Abagayle Martin..... Bath County
William Gage Thompson..... Bath County
Addison Banks..... Bourbon County
Dixie Barnett..... Bourbon County
Kelby Carpenter..... Bourbon County
Shelby Davis..... Bourbon County
Ruby DeAtley..... Bourbon County
Carlie Eubank..... Bourbon County
Addison Felty..... Bourbon County
Breanna Hardin..... Bourbon County
Makenzie Jolly..... Bourbon County
Bradley Laytart..... Bourbon County
Kaylee Mirabito..... Bourbon County
Cole Nichols..... Bourbon County
Bailey Rorer..... Bourbon County
Clifton Sapp..... Bourbon County
Annaleigh Sidles..... Bourbon County
Katelynn Smits..... Bourbon County
Macie Sparks..... Bourbon County
Allyson Price..... Boyle County
Ella Burton..... Bracken County
Makenzie Rudd..... Bracken County
Elizabeth Ball..... Breckinridge County
Tyler Davis..... Breckinridge County
Kenley Rhodes..... Breckinridge County
Allison Tucker..... Breckinridge County
Jon Beavers..... Caldwell County
Abbigail Drennan..... Caldwell County
Landry Dunbar..... Caldwell County
Madison French..... Caldwell County
Meleah Greenfield..... Caldwell County
Gloria Jones..... Caldwell County
Kaden Morris..... Caldwell County
Sutton Ritchey..... Caldwell County
Alexander Sample..... Caldwell County
Hannah Teutsch..... Caldwell County
Addison Thompson..... Caldwell County
Peyton Ward..... Caldwell County
Laila York..... Caldwell County
Abigail Hathcock..... Calloway County
Luke Johnson..... Calloway County
Dakotah Pittman..... Calloway County
Elijah Rudolph..... Calloway County
Jonah Bruer..... Carlisle County
Kase Kelly..... Carlisle County
Chase Murphy..... Carlisle County
Kaidance Vela..... Carlisle County
Houston Parker..... Carroll County
Faustin Luka..... Carter G. Woodson
Cierra Couch..... Casey County
Brayden Irvin..... Casey County
Jake Weddle..... Casey County
Molly Burba..... Central Hardin
LeeAna B. Green..... Central Hardin
Katherine Meals..... Central Hardin

State Degree Candidates

Avery Miller	Central Hardin	Shannon Kate Matthews	
Adysen Mae Williams	Central Hardin	Grayson County	
Brant Cansler	Christian County	Finley Corrigan	Great Crossing
Dalton Combs	Christian County	Abby Darnell	Great Crossing
Addison Gilkey	Christian County	Will Glass	Great Crossing
Preston Blackburn	Clark County	Emily Jones	Great Crossing
Olivia Bretz	Clark County	Katie McFarland	Great Crossing
Kody Hatton	Clark County	Madi Schalnus	Great Crossing
Aden Henson	Clark County	Emily Shipley	Great Crossing
Tyler Henson	Clark County	Nathan Walling	Great Crossing
Matthew Jones	Clark County	Eli Thompson	Green County
Megan Robinson	Clark County	Josie Crum	Greenup County
Hagan Walters	Clark County	Abby Imel	Greenup County
Addy Wyatt	Clark County	Zoey Keyes	Greenup County
Logan Brumley	Clinton County	Carleigh Marshall	Greenup County
JP Cross	Clinton County	Ryan McGinnis	Greenup County
Amber Gilbert	Clinton County	Josie Mullins	Greenup County
Keaton McIver	Clinton County	Colton Ream	Greenup County
Keaton Pitman	Clinton County	Kevin Scaggs	Greenup County
Kaycee Pittman	Clinton County	Jordan Willis	Greenup County
Nevina Shelton	Clinton County	Kelsie Willis	Greenup County
Lydia Dalbey	Conner Senior	Ethan Barnes	Greenwood
Abigail Abdon	Cooper	Makayla Eleson	Greenwood
Lynlee Higgins	Cooper	Lily Porter	Greenwood
Alyssa Johnson	Cooper	Darrion Wells	Greenwood
Colton Kearns	Cooper	Wilson Barnes	Harrison County
Michael Lamkin	Cooper	Jade Bennett	Harrison County
Nathan Payne	Cooper	Nicholas Craycraft	Harrison County
Pollyanna Vaske	Cooper	Ava Denniston	Harrison County
Jackson Wooten	Cooper	Brooklynn French	Harrison County
Madison Walker	Crittenden County	Madison Jones	Harrison County
Jordyn McDonald	Cumberland County	Macayla Pike	Harrison County
Johnathan Berry	Daviess County	Sarra Skinner	Harrison County
Campbell Crabtree	Daviess County	John Sowder	Harrison County
Carter Crabtree	Daviess County	Tim Sullivan	Harrison County
Charles Evans	Daviess County	Cade Tobin	Harrison County
Wyatt Hayes	Daviess County	Marlie Tolle	Harrison County
Kailee Lanham	Daviess County	Hannah Wagoner	Harrison County
Ariana Martinez	Daviess County	Sam Workman	Harrison County
Brennan Pate	Daviess County	Clay Zumwalt	Harrison County
Ezekiel Payne	Daviess County	Lily Alvey	Hart County
Kendall Brammell	East Carter	Lanee Froggett	Hart County
Greyson Jackson	East Carter	Brilyne Highbaugh	Hart County
Levi Lucas	East Carter	Bailey Moore	Henderson County
Keylee Jurisich	Edmonson County	Emma Moseley	Henderson County
Peytin Manor	Edmonson County	Annaleigh Richard	Henderson County
Holly Simmons	Edmonson County	Zeke Nicholas	Hickman County
Kathryn Gilliam	Elliott County	Addison Blanchard	Hopkins Central
EmiLee Calmes	Estill County	Madolyn Brown	Hopkins Central
Adyson Lyons	Franklin County	McKenna Hackney	Hopkins Central
Maxwell Perry	Franklin County	Kalli Hancock	Hopkins Central
Aiden Presley	Franklin County	Gracie Strader	Hopkins Central
Cara Capps	Fulton County	Anthony Webster	Hopkinsville
Brianna Gayle Griffin	Gallatin County	McKenna Jackson	Horizons
Alexis Rylee Perry	Gallatin County	Creighton Smith	Horizons
Rachel Brown	Garrard County	Katelynn Bowles	Jackson County
Zenya Christovassilli	Garrard County	Jacob Collett	Jackson County
Zoe Jordan	Garrard County	Jalee Davis	Jackson County
Roselyn R. Bass	Grant County	Lauren Jackson	Jackson County
Emma Mullins	Grant County	Leigha Metcalf	Jackson County
Jackson W. Traylor	Grant County	Ary Miller	Jackson County
Avery Anne Wolfe	Grant County	Anna Roark	Jackson County
Brandon Hale	Graves County	Addan Witt	Jackson County
Mannix Hamilton	Graves County	Hannah York	Jackson County
Karlee Peeler	Graves County	Adeline Ellsworth	Jessamine County
Darcey Sloan	Graves County	Jazmily Blakely	Knox Central
Caleb Walton	Graves County	Cayleb B. Brangers	LaRue County
Kathryn Woolf	Graves County	Aeryn Grimes	LaRue County
Maggie Basham	Grayson County	Joslyn Hinton	LaRue County
Cassie L. Copelin	Grayson County	Luanna M. Huff	LaRue County
Avery E. Davis	Grayson County	Miguel Salazar	LaRue County
Kyle Green	Grayson County	Emily Holbrook	Lawrence County

State Degree Candidates

Mikka Horn	Lawrence County	Guylee Carrier	Mercer County
Allison Maynard	Lawrence County	Addison Arnold	Montgomery County
Kelsey Vance	Lawrence County	Emma Branham	Montgomery County
Ella Bratcher	Lincoln County	Sydney Butcher	Montgomery County
Shelby Howard	Lincoln County	Sophia Combs	Montgomery County
Kaya Jones	Lincoln County	Lilly Coyle	Montgomery County
Autumn McCuffey	Lincoln County	Zoe Bradley	Morgan County
William Peek	Lincoln County	Hannah Lykins	Morgan County
Rylee Hall	Livingston Central	Bailey Adams	Nelson County Schools
Josie Taylor	Livingston Central	Allie Elizabeth Arnold	Nelson County Schools
Kenley Foster	Locust Trace	Nelson County Schools	
Addison Gayne	Locust Trace	Landon Miller	Nelson County Schools
Addison Hillard	Locust Trace	Landon Cox	Nicholas County
Riley Hutchison	Locust Trace	Leia Dixon	Nicholas County
Abbie Knox	Locust Trace	Caleb Hopkins	Nicholas County
Samantha Kroggel	Locust Trace	Embrie Kenney	Nicholas County
Haylee Tucker	Locust Trace	Kaden Leggett	Nicholas County
Kenja Vargas	Locust Trace	Abigail McNabb	Nicholas County
Makayla Head	Logan County	Nicole Mitchell	Nicholas County
Connor Thomas	Logan County	Skyler Ring	Nicholas County
Kyleigh Smith	Logan County	Jayden Robinson	Nicholas County
Kingsley Stratton	Logan County	Olivia Rodgers	North Bullitt
Colt White	Logan County	Victoria Wooldridge	North Bullitt
Caleb Williams	Lynn Camp	Savannah Jackson	North Laurel
Adison Baker	Lyon County	Khloe Coffman	Ohio County
Kayla Dunn	Lyon County	Brayden Baker	Owen County
Peyton Allen	Madison Southern	Samuel Banks	Owen County
Eldon Benton	Madison Southern	Callie Fitzgerald	Owen County
Jack Bowling	Madison Southern	Grayson Rogers	Owen County
Dakota Butler	Madison Southern	Delaney Tabor	Owen County
Caleb Mason	Madison Southern	Isabella Roberts	Pendleton County
Hope Schneier	Madison Southern	Amelia Barnes	Powell County
Maggie Killough		Madison Hensley	Powell County
Madisonville North Hopkins		Travis Myers	Powell County
KariMartinMadisonville North Hopkins		Maddie Patrick	Powell County
Lillian Norman		McKinley Patrick	Powell County
Madisonville North Hopkins		Brandy Rogers	Powell County
Addilynn Bartley	Marion County	Gracyln Campbell	Pulaski County
Andrew Bright	Marion County	Natalie West	Pulaski County
Kinley Craig	Marion County	Henry Haag	Robertson County
Phebe Jones	Marion County	Elizabeth Murrell	Robertson County
Piper Jones	Marion County	Ally Hayes	Rockcastle County
Maddie Lamkin	Marion County	Hannah King	Rockcastle County
Andrew Mattingly	Marion County	Kayla Miller	Rockcastle County
Charlie Mattingly	Marion County	Cailee Mullins	Rockcastle County
Brianna Burgess	Marshall County	Phoenix Pitman	Rockcastle County
Blake Goranson	Marshall County	Ainslee Renfro	Rockcastle County
Maria Grace	Marshall County	Abby Fox	Russell County
Wyatt Holley	Marshall County	Kendall Melton	Russell County
Brighton Newnum	Marshall County	Blane Smith	Russell County
Maggie Ralph	Marshall County	Jared Napier	Ryle
Keenan Galloway	Mason County	Kynnedi Gray	Scott
Carter Churchwell	McCracken County	Gracesyn Akers	Scott County
Bailey Heider	McCracken County	Savannah Allen	Scott County
Brooke Lay	McCreary Central	Benjamin Blakenship	Scott County
Camry Snyder	McCreary Central	Clara Blethen-Small	Scott County
Lindsay Wilmot	McCreary Central	Mackenzie Colwell	Scott County
Wyatt Gatton	McLean County	Isabella Jacobs	Scott County
William Hardesty	Meade County	Aiden Legear	Scott County
Shyann Keith	Meade County	Sara Moberly	Scott County
Courtney Ogle	Meade County	Olivia Price	Scott County
Makayla A. Pike	Meade County	Kirstin Bowles	Seneca
Sandra Vessels	Meade County	Kannia Davis	Seneca
Patrick Abney	Menifee County	Deborah Elbert	Seneca
Aiden Hunt	Menifee County	Angel Flener	Seneca
Reagan Skidmore	Menifee County	Jillian Fraiser	Seneca
Ella Smallwood	Menifee County	Kyler Kuprion	Seneca
Jacob Smith	Menifee County	Izzy Probus	Seneca
Shawn Wells	Menifee County	De Mayiah L. Stephenson	Seneca
Eli Yates	Menifee County	Hailey Anderson	South Laurel
Emma Camden	Mercer County	Marli Hale	South Laurel

State Degree Candidates

Abigail Rogers.....	South Laurel	Joseph Mosley.....	Warren Central
Tanner Sams.....	South Laurel	Bryant Eadens.....	Warren East
Brayden Warren.....	South Laurel	Juli'anna Parrish.....	Warren East
Alyza Lawson.....	Southwestern Pulaski	Sean Root.....	Warren East
Julie Patterson ..	Southwestern Pulaski	Matthew Strode.....	Warren East
Claire Beth Peterson.....	Southwestern Pulaski	Lucas Brothers.....	Washington County
Karly Roy.....	Southwestern Pulaski	Owen A. Edelen....	Washington County
Abigail Crane.....	Spencer County	Annaliese M. Hardin.....	Washington County
Gavin Goode.....	Spencer County	Mary B.Matherly...	Washington County
Seth Monroe.....	Spencer County	Claire M. McCain ..	Washington County
Jose Ponce.....	Spencer County	Jackson C. Stevens.....	Washington County
Kendall Slaughter.....	Spencer County	Ava Atkinson.....	Wayne County
James Ryan Tobbe.....	Spencer County	Allison Bell.....	Wayne County
Winter Turner.....	Spencer County	Kiley Bell.....	Wayne County
Lydia Bennett.....	Taylor County	Ainslee Dolen.....	Wayne County
Alyssa Benningfield.....	Taylor County	Gavin Brown.....	Webster County
Raylee Cruz.....	Taylor County	Saydee Cowan.....	Webster County
Timothy Farmer.....	Taylor County	Alyssa C. Lovan.....	Webster County
Caleb Feather.....	Taylor County	Hunter Redfern.....	Webster County
Cole McLean.....	Taylor County	Grayci Waddell.....	Webster County
Haiden Russell.....	Taylor County	Ella Bush.....	West Carter
Andrea Scott.....	Taylor County	Alex Henderson.....	West Carter
Braydn Spurling.....	Taylor County	Macey Holbrook.....	West Carter
Jaxton Wood.....	Taylor County	Trevor Jones.....	West Carter
Sadie Young.....	Taylor County	Tanner Kinney.....	West Carter
Silas Young.....	Taylor County	Roy Utley.....	West Carter
Allyssa Clardy.....	Todd Central	Mckinzie Tayler Bettencourt.....	Western Hills
Rylann Griggs.....	Todd Central	Skylar Bowman.....	Western Hills
Ethan Hall.....	Todd Central	Sarah DeLong.....	Western Hills
Meredith Hampton.....	Todd Central	Allie Hill.....	Western Hills
Will McGhee.....	Todd Central	Addison Judy.....	Western Hills
Thomas Wade Morse.....	Todd Central	Stephen Lemon.....	Western Hills
Nathan Phelps.....	Todd Central	Shyann McIntyre.....	Western Hills
Jon Luke Robertson.....	Todd Central	Freddy Musinski.....	Western Hills
Alexus Shackelford.....	Todd Central	Cheyenne Robinson.....	Western Hills
Joe Anthony Tabor.....	Todd Central	Jaida Snow.....	Western Hills
Addison Woodall.....	Todd Central	Peyton Zinner.....	Western Hills
Akia Kearney.....	Trigg County	Jalynn Grubb.....	Whitley County
Makaila Blake.....	Union County	Landrey Prewitt.....	Whitley County
Ethan Byrd.....	Union County	Bianca Watson.....	Whitley County
Cailey Divine.....	Union County	Emily Cooper.....	Williamsburg Independent
Isaiah Gibson.....	Union County	Cabela Johnson.....	Williamsburg Independent
Kyra Meeks.....	Union County	Faith Davis.....	Woodford County
Ava Rich.....	Union County	Carolina Rhea.....	Woodford County
Judy Scott.....	Union County	Emma Roberts.....	Woodford County
Addison Wesmoland.....	Union County		
Alec Wolfe.....	Union County		
Russell Burdette.....	Walton-Verona		
Aubrey Hamilton.....	Walton-Verona		



KCTCS.EDU



Kentucky FFA State Convention

One-Star Sponsors

- 2007-2008 Kentucky FFA State Officer Team
- Agribusiness Association of Kentucky
- Bluegrass Region FFA In Memory of Neal Floyd
- Cal Maine Foods
- Dr. Tony & Lisa Brannon
- Hallway Feeds
- Hardin County Farm Bureau
- Hutson, Inc.
- Jeff and Morissa Hayes
- Jimmie & Betty Claycomb
- Jonathan Fox
- Ken and Brenda Reed
- Kentucky Association of Agricultural Educators
- Kentucky Corn Growers Association
- Kentucky Dairy Development Council
- Kentucky Division of Forestry
- Kentucky Retail Federation
- Kentucky Sheep & Goat Development Board
- Kentucky State Horticultural Society
- Kentucky Young Farmers Association
- Little Kentucky Smokehouse
- Matt & Betsy London
- Meade Stock Farm - ALR Farms LLC
- Mr. Billy Ray Smith
- Mr. Damon Talley
- Paris Stockyards
- Pulliam & Associates Consulting
- Randal Williamson
- Rip's Farm Center
- Robey Farms
- Ryan Brothers
- Southern States
- Syngenta Crop Protection, Inc.
- The Late Dr. Charles Byers Endowment
- The Late Dr. Luther & Brenda Hughes Forever Blue Endowment
- The Late John Colliver Endowment
- The Lawrence Hall Trust
- The Murray Bank & Furches Farms Partnership
- The Stith Brothers
- Wright Implement



A HOME-GROWN LEGACY

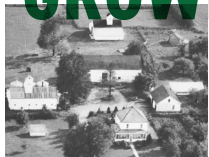

A legacy of faith. A tradition of farming. A future rooted in both.

Kentucky FFA State Stars

STAR FARMERS

1942—Calvert Kelsey.....	Stamping Ground
1943—Charles V. Bean.....	Bardstown
1944—William Vallandigham.....	Sadieville
1945—John Rhoderer.....	Jeffersontown
1946—Joe E. Whittington.....	Bloomfield
1947—Eddie Mylor.....	Gallatin County
1948—Georgee Thompson, III.....	Daviess County
1949—Richard Marcum.....	Madison Central
1950—Bobby Snedegar.....	Owingsville
1951—Robert Shipp.....	Sonora
1952—Ray Bradshaw.....	Nicholasville
1953—Ralph Bradford.....	Butler
1954—Kenny Reed.....	Versailles
1955—Howard Downing.....	Nicholasville
1956—James A. Pace, Jr.....	Ballard Memorial
1957—Billy Joe Mitchell.....	North Warren
1958—Bobby Charles Thompson.....	Athens
1959—Danny Duvall.....	Bristow
1960—Dickie Cooper.....	Hustonville
1961—Billy Lee Bradshaw.....	Jessamine County
1962—Thomas W. Stinson.....	Adairville
1963—Robert W. Thompson, Jr.....	Jessamine County
1964—Tommy Porter.....	Christian County
1965—Joe William Meng.....	Warren County
1966—Gene Warren.....	Henderson County
1967—William Earl Ransdell.....	Mercer County
1968—Donny Ray Jasper.....	Jessamine County
1969—Mike Millikan.....	Lyon County
1970—Bill Dotson.....	Hazel Green
1971—Homer L. Richardson.....	Meade County
1972—Thomas Hardesty.....	Meade County
1973—Bobby Hobbs.....	Fancy Farm
1974—Richard White.....	Union County
1975—Michael S. Mitchell.....	Woodford County
1976—Richard M. Askew.....	Caldwell County
1977—Steven Knoth.....	Livingston Central
1978—Kenneth Paschall.....	Calloway County
1979—Drew Graham.....	Clark County
1980—Jeff Estes.....	Warren East
1981—Mark Travis.....	Spencer County
1982—Timmy Quiggins.....	Breckinridge County
1983—Bobby Hines.....	Daviess County
1984—Barry Hines.....	Daviess County
1985—Kevin Gardner.....	Barren County
1986—Paul A. Miles.....	Apollo
1987—Timothy Baker.....	Adair County
1988—Gregory Allen Willoughby.....	Allen County-Scottsville
1989—Matthew S. Snowden.....	Powell County
1990—Amy Olt.....	Green County
1991—Michael Camenisch.....	Lincoln County
1992—J. Ryan White.....	Union County
1993—Thomas S. Gish.....	McLean County
1994—Chris Robey.....	Logan County
1995—Victoria Cannon.....	Fleming County
1996—Neal Ballance.....	Greenwood
1997—Steven Olt.....	Green County
1998—Josh Seagraves.....	Central Hardin
1999—Anna Fisher.....	Allen County-Scottsville

2000—Patrick Carrier	Lincoln County
2001—Stephanie Issacs	Hart County
2002—Casey Chittenden	Livingston Central
2003—Eli Robey	Logan County
2004—Jarred Ayres	Garrard County
2005—Brady Core	Mercer County
2006—Austin Joseph	Marshall County
2007—Drew Langley	Central Hardin
2008—Brian Reynolds	LaRue County
2009—Alex Richardson	Meade County
2010—Jordan Settles	Washington County
2011—Kari Buntin	Crittenden County
2012—Stefan Fink	Clark County
2013—Morgan Phillips	Fleming County
2014—Caleb Brannon	Calloway County
2015—Rebecca Mobley	Spencer County
2016—James Clay Ballinger	Rockcastle County
2017—Jonah Brannon	Calloway County
2018—Lauren Schmitt	Livingston Central
2019—Logen Winfield	Apollo
2020—Randall Mattingly	Marion County
2021—Luke Millay	Meade County
2022—Lyndsey Garrett	Nicholas County
2023—Jeffrey Spowles	Taylor County
2024—Riley Pierce	Southwest Pulaski
2025—Colson Pierce	Southwest Pulaski

STARS IN AGRIBUSINESS

1988—Gregory D. Walker	Green County
1989—Brian Holder	Paducah-Tilghman
1990—Brent White	Lyon County
1991—Ben Lee	Apollo
1992—Andrew D. Koostra	Warren Central
1993—Jason Karrer	Spencer County
1994—William Matthew Rudy	Ballard Memorial
1995—Jeff Chapman	Barren County
1996—Steven Rudy	Ballard Memorial
1997—Jason Isaacs	Jackson County
1998—Lee Herring	Madisonville-North Hopkins
1999—Lory Beth Holbrook	Wolfe County
2000—Kyle Atchison	Henry County
2001—Kenton Abrams	Oldham County
2002—Kimberly Angel	Jackson County
2003—Craig Howard	McLean County
2004—Jordan Hack	Oldham County
2005—Jarrod Farley	Henderson County
2006—Jacob Whitaker	Jackson County
2007—Jared Ervin	Green County
2008—Ethan Crawford	Bourbon County
2009—Zach Cotton	Spencer County
2010—Megan McCoy	Montgomery County
2011—Kyle Howard	McLean County
2012—Courtney Cox	Spencer County
2013—Alexis Skaggs	John Hardin
2014—Darilyn Hamilton	Spencer County
2015—Kaitlyn Elliott	Boyle County
2016—Blake Quiggins	Hart County
2017—Wayd Wood	McCracken County
2018—Hannah York	Caldwell County
2019—Matthew Rowlette	Madison Southern
2020—Mason Dixon	Taylor County
2021—Olivia Moore	Western Hills
2022—Katharine Woodward	Logan County

2023—Morgan Shipp Williamstown Independent
 2024—Carsen Thompson Green County
 2025—Laney Pease Fleming County

STARS IN AG PLACEMENT

2003—Richard Medley Washington County
 2004—Jilian Warren Washington County
 2005—Matt Suiter Todd County Central
 2006—Jonathan Shell Garrard County
 2007—Evan Head Crittenden County
 2008—James Sledd Reidland
 2009—Jessica Diel Graves County
 2010—Carlye Graff Spencer County
 2011—Hillary Page Reidland
 2012—Emily Hume Spencer County
 2013—Katie McKinney Spencer County
 2014—Michael Lacy Morgan County
 2015—Alisha Prewitt Whitley County
 2016—Wyatt Wood McCracken County
 2017—Austin Ballou Southwestern Pulaski
 2018—Justin Arnett Montgomery County
 2019—Colton George- Caldwell County
 2020—Sydney Pepper LaRue County
 2021—Jordan Reddick Carlisle County
 2022—Braden Compton Meade County
 2023—Madison Frogue Todd Central
 2024—Caleb Canada Whitley County
 2025—Wade Moore Henry County



Proud Supporters of



Proud Supporters of





***farm*CREDIT
MID-AMERICA**

**WE DO MORE THAN LEND.
WE LIFT UP.**

We're proud to support the next generation of industry leaders through our partnership with FFA, helping equip them with the tools and resources to rise to challenges in their communities and the agriculture industry.

**SCAN HERE TO
LEARN MORE ABOUT
HOW WE ARE
SUPPORTING THE
NEXT GENERATION
OF AGRICULTURE .**

